

OMRON Photoelectric Sensors



OMRON E3F2 SERIES: M18 CYLINDRICAL PHOTOELECTRIC SENSORS

Specifications:

- Housing material: Plastic or Nickel plated brass (NPB)
- Connection method: 2m cable
- Supply voltage: AC models - 24-240 VAC; DC models - 10-30 VDC
- Response time: AC models - 30 ms max.; DC models - 2.5ms max.
- Enclosure Rating: IEC IP66; NEMA 4
- Through-beam models include emitter and receiver pair
- Retroreflective type is non-polarized

Features:

- Threaded with built-in amplifier
- PVC cable sheath
- Compact and space-saving
- Watertight construction
- DC switching types available with connector connection upon request



For quantities of 20 and up, call for quote.

MOUSER STOCK NO.	Omron Part Number	Type	Light Source	Sensing	Range	Body Material	Price Each		
							1	5	10
AC Supply									
653-E3F2-DS1N	E3F2-DS10Z1-N	Diffuse	Infrared LED	Light-On	100mm	Plastic	77.13	75.35	73.26
653-E3F2-DS2N	E3F2-DS10Z2-N	Diffuse	Infrared LED	Dark-On	100mm	Plastic	95.45	91.60	86.71
653-E3F2-R2Z1	E3F2-R2Z1	Retroreflective	Infrared LED	Light-On	2m	Plastic	79.31	76.54	74.29
653-E3F2-R2Z2	E3F2-R2Z2	Retroreflective	Infrared LED	Dark-On	2m	Plastic	100.94	95.60	92.18
653-E3F2-3Z2	E3F2-3Z2	Through-beam	Infrared LED	Dark-On	3m	Plastic	145.07	137.02	133.12
DC Supply									
653-E3F2-DS4N	E3F2-DS10C4-N	Diffuse	Infrared LED	NPN	10cm	Plastic	66.73	65.93	63.47
653-E3F2-DS4M	E3F2-DS10C4-M	Diffuse	Infrared LED	NPN	10cm	NPB	91.06	79.30	75.72
653-E3F2-R4C4	E3F2-R4C4	Retroreflective	Infrared LED	NPN	4m	Plastic	71.33	61.45	58.62
653-E3F2-7C4	E3F2-7C4	Through-beam	Infrared LED	NPN	7m	Plastic	97.27	93.97	91.05
Accessories							Description		
653-Y92E-B18	Y92E-B18	Sensor mounting bracket					3.00	2.60	2.46
653-E39-RSA	E39-RSA	Adhesive back reflector sheet, size 35x10mm					8.22	7.59	6.97
653-E39-RSB	E39-RSB	Adhesive back reflector sheet, size 40x35mm					11.35	9.27	8.84
653-E39-R1	E39-R1	Reflector - supplied w/retroreflective units, 100mm-6m sensing					13.45	10.15	9.67
653-E39-L7	E39-L7	Mounting bracket for E39-R1 reflector (not supplied with reflector)					5.70	5.17	4.55

E3F2 Series

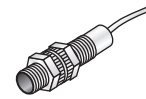

E3F2-DS10C4-N
E3F2-DS10C4-M
E3F2-R4C4
E3F2-7C4
E3F2-DS10Z1-N
E3F2-DS10Z2-N
E3F2-3Z2
E3F2-R2Z1
E3F2-R2Z2

Accessories

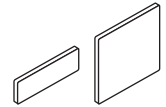

Adhesive backed reflector (E39-RSA) (E39-RSB)



Reflector (E39-R1)

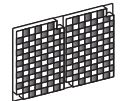

Reflector (E39-R2)

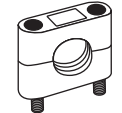

Sensor mounting bracket (Y92E-B18)



Mounting bracket (E39-L131)

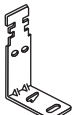

Mounting bracket (E39-L59)

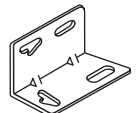

Mounting bracket (E39-L69) (E39-L7)



R/A cordset (Y96E-43RD10)

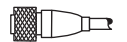

Straight cordset (Y96E-43SD10)

E3G Series

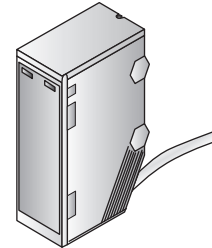

E3G-R13

E3S-A Series

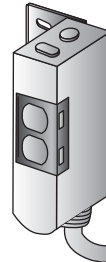

E3S-AT61
E3S-AR61

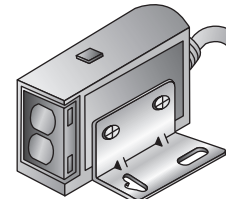

E3S-AT11
E3S-AR11



E3S-AR86

OMRON E3G SERIES: LONG DISTANCE PHOTOELECTRIC SENSORS

Specifications:

- Operation mode: Light-ON/Dark-ON switch selectable
- Supply voltage: 10 - 30 VDC
- Sensitivity adjustment: E3G-R13 - 1-turn potentiometer; E3G-L73 - Teaching
- Retroreflective type is non-polarized
- Response time: E3G - 1ms; E3G-L73 - 5ms
- Connection method: 2m cable

Features:

- Circuit protection from reversed power supply connection, load short-circuit, and mutual interference
- E39-R2 reflector is supplied with E3G-R13 sensor
- E3G-L73 has a "Teach" mode, allowing for one-point teaching, two-point teaching, and zone teaching



For quantities of 20 and up, call for quote.

MOUSER STOCK NO.	Omron Part Number	Type	Light Source	Output	Range	Price Each		
						1	5	10
653-E3G-R13	E3G-R13	Retroreflective	Red LED	NPN/PNP	500 mm - 10 m	164.99	159.38	154.43
Accessories						Description		
653-E39-R1	E39-R1	Reflector, 100mm-6m sensing				13.45	10.15	9.67
653-E39-R2	E39-R2	Reflector - supplied with retroreflective units, 500mm-10m sensing				19.46	14.99	13.56
653-E39-L131	E39-L131	Sensor mounting bracket				7.79	7.39	6.97
653-E39-L7	E39-L7	Mounting bracket for E39-R1 reflector				5.70	5.17	4.55

OMRON E3S-A SERIES: COMPACT PHOTOELECTRIC SENSORS

Specifications:

- Supply voltage: 10 - 30 VDC
- Response time: 0.5 ms max. ON, 0.5 ms max. OFF
- Operation Mode: Light-ON/Dark-ON, switch selectable
- Light source: Red LED
- Retroreflective type is polarized
- Pre-wired versions have 2m cable

Features:

- Enclosure meets NEMA 4X, 6, and IP67
- User-friendly features for ease of installation and use
- Mounting bracket E36-L69 supplied with horizontal sensors
- Mounting bracket E36-L70 supplied with vertical sensors
- Retroreflective sensors include E39-R1 reflector
- Through-beam sensors include both emitter and receiver



For quantities of 20 and up, call for quote.

MOUSER STOCK NO.	Omron Part Number	Type	Mounting Position	Output	Range	Connection Method	Price Each		
							1	5	10
653-E3S-AT11	E3S-AT11	Through-beam	Horizontal	NPN	0-7m	Pre-wired	185.57	179.26	173.70
653-E3S-AT61	E3S-AT61	Through-beam	Vertical	NPN	0-7m	Pre-wired	185.57	179.26	173.70
653-E3S-AR11	E3S-AR11	Retroreflective	Horizontal	NPN	0.1-2m	Pre-wired	159.20	153.79	149.01
653-E3S-AR61	E3S-AR61	Retroreflective	Vertical	NPN	0.1-2m	Pre-wired	159.20	153.79	149.01
653-E3S-AR86	E3S-AR86	Retroreflective	Vertical	PNP	0.1-2m	Connector	162.50	156.98	152.10
Accessories							Description		
653-E39-RSA	E39-RSA	Adhesive back reflector sheet, size 35x10mm				8.22	7.59	6.97	
653-E39-RSB	E39-RSB	Adhesive back reflector sheet, size 40x35mm				11.35	9.27	8.84	
653-E39-R1	E39-R1	Reflector, 100mm-6m sensing				13.45	10.15	9.67	
653-E39-L59	E39-L59	Vertical mtg. bracket for vertical sensors (2 required for through-beam)				5.45	5.17	4.55	
653-E39-L69	E39-L69	Mounting bracket for vertical sensors (supplied with each sensor)				7.79	7.17	6.40	
653-Y96E-43SD10	Y96E-43SD10	Straight connector cordset, 10m cable				23.00	21.53	20.15	
653-Y96E-43RD10	Y96E-43RD10	Right angle connector cordset, 10m cable				23.00	21.53	20.15	